

South Carolina Statewide Survey Site Form

State Historic Preservation Office
P.O. Box 11449 • Columbia, SC • 29211 • (803)734-6449

IDENTIFICATION

1. Correl Number 11-21-0001 / 608 318 2. NR Milefile (only if _____)

3. Historic name(s): Bank Street Home
city county census designated place zip

4. Common name: _____

5. Address/location: Shaver Rd. S side, 0.1 mi. S from Meeting/Shaver Rd.

City: _____ Vicinity of: _____ County: York

6. Ownership: private city county state federal 8. Current use(s): single dwelling multi dwelling

7. Category: building site structure object 9. Commercial office

10. Historic use(s): single dwelling multi dwelling commercial 10. Potential: NR historic district

11. Statefile(s): listed individually in National Register name: _____
other (S)

- listed as part of NR historic district Name of district: _____
- contributing non-contributing
- listed individually National Historic Landmark
- determined eligible versus objection
- determined NOT eligible
- deferred by review board
- rejected by Washington
- removed from NR
- removed from survey
- pending federal nomination
- completed Preliminary Information Sheet (PIS)
- part of NPS, State
- DSH process
- rejected by review board
- removed from NR
- removed from survey
- demolished
- nomination on file/never processed

12. Number of contributing properties: _____

PROPERTY DESCRIPTION: When other (2) is chosen, enter date on reverse side under category 20 or 21.

13. Destruction Date 1918 14. Alteration Date _____ 15. Architectural style or influence I-Renaissance

16. Commercial Form -- circle appropriate response(s)

- | | | | |
|--|---|---|---|
| <input type="checkbox"/> 1 2-part commercial block | <input type="checkbox"/> 3 stacked vertical block | <input type="checkbox"/> 4 temple front | <input type="checkbox"/> 5 Central Block w/ wings |
| <input type="checkbox"/> 2 3-part commercial block | <input type="checkbox"/> 4 2-part vertical block | <input type="checkbox"/> 6 vault | <input type="checkbox"/> 6 graded block |
| <input type="checkbox"/> Combined window wall | <input type="checkbox"/> 5 3-part vertical block | <input type="checkbox"/> 7 entrance block | <input type="checkbox"/> 7 other |

17. DESCRIPTION: Select as many responses as appropriate

- | | | | |
|---|--|---|--|
| <p>A) HISTORIC CORE SHAPE</p> <ul style="list-style-type: none"> rectangle (1) square (2) L (3) T (4) U (5) H (6) irregular (7) triangular (8) other (9) | <p>B) ROOF SHAPE</p> <ul style="list-style-type: none"> gable (end to front) (1) gable (front) (2) hip (3) cross gable (4) pyramidal (5) flat (6) truncated hip (7) garret (8) mansard (9) cut box (10) perched (11) gable-on-hip (12) mono-pitch (14) not visible (15) other (16) | <p>F) PORCH ROOF SHAPE</p> <ul style="list-style-type: none"> shed (1) hip (2) gable (3) perforated gable (4) flat (5) engaged (6) partially engaged (7) gable-on-hip or shed (8) engaged pure modern (9) other (10) | <p>H) WINDOWS</p> <ul style="list-style-type: none"> single (1) double (2) tripartite (3) grouped (4) decorative (5) display (6) other (7) |
| <p>B) STORIES</p> <ul style="list-style-type: none"> 1 story (1) 1 1/2 stories (2) 2 stories (3) 2 1/2 stories (4) 3 stories (5) other (6) | <p>E) NORTH WIDTH</p> <ul style="list-style-type: none"> entrance bay only (1) over 1 bay, less than full facade (2) full facade (3) facade & left elevation (4) facade & right elevation (5) facade & both elevations (6) other (7) | <p>C) NUMBER OF STORIES</p> <ul style="list-style-type: none"> 1, exterior (1) 1, interior only (2) 1, exterior (3) 1, interior (4) 1, flat roof (5) ...not double (6) ...not visible (7) ...other (8) | <p>D) PANE CONFIGURATION</p> <ul style="list-style-type: none"> inscribed (1) Queen Anne Mock glass (2) French/Burgundian/Archaic geometric (3) not visible (4) other (5) |
| <p>C) PORCH HEIGHT</p> <ul style="list-style-type: none"> 1 story (1) 1 story w/ deck (2) 1 or more stories (3) 1 or more with ramp (4) roofed balcony over 1 story (5) split-level (6) other (7) | <p>G) 20, 21</p> <ul style="list-style-type: none"> 1, L 1, H 1, S 1, T 1, U 1, other (6) | | |



E) CONSTRUCTION METHOD

masonry (1)
 frame (2)
 log (3)
 nail (4)
 other (5)

L) EXTERIOR WALLS

weatherboard (1)
 beaded weatherboard (2)
 shingle (3)
 flashboard (4)
 wood shingle (5)
 stone (6)
 lath (7)
 brick (8)
 brick veneer (9)
 stone veneer (10)
 caststone (11)
 marble (12)
 asphalt roll (13)
 synthetic siding (14)
 asbestos shingle (15)
 pigmented cement
 plaster (16)
 other (17)

M) PORCH DETAILS

clashed posts (1)
 turned posts (2)
 supports on pedestals (3)
 columns (4)
 posts (5)
 piers (6)
 pilars (7)
 bracing posts (8)
 balustrade (9)
 apron wall (10)
 turned balusters (11)
 decorative iron balusters (12)
 cast balusters (13)
 other architectural work (14)
 insect screening (15)
 post anchors (16)
 other (17)

N) CHEIMNEY MATERIAL

brick (1)
 masonry brick (2)
 stone (3)
 brick & stone (4)
 other (5)

O) ROOF MATERIAL

composition shingle (1)
 pressed metal shingle (2)
 wood shingle (3)
 slate (4)
 tiled iron metal (5)
 other metal (6)
 rolled roofing (7)
 not visible (8)
 tile (9)
 other (10)

P) FOUNDATION

not visible (1)
 brick pier (2)
 brick pier with sill (3)
 brick (4)
 masonry masonry (5)
 stone pier (6)
 stone (7)
 concrete block (8)
 slab construction (9)
 basement (10)
 raised basement (11)
 other (12)

Q) DECORATIVE ELEMENT MATERIAL

cast iron (1)
 pressed metal (2)
 terra cotta (3)
 granite (4)
 marble (5)
 cast stone (6)
 brick (7)
 wood (8)
 pigmented glass (9)
 stone (10)
 stone (11)
 other (12)

R) INTERIOR FEATURES

II. HISTORIC OUTBUILDINGS AND STRUCTURES:

none (1)
 none visible (2)
 garage (3)
 garage w/ living area (4)
 shed (5)
 kitchen (6)

tenant house (7)
 other house (8)
 office (9)
 barn (10)
 tobacco barn (11)
 dairy (12)

well (13)
 windmill (14)
 stone house (15)
 privy (16)
 well (17)
 synchrotron (18)

stone (19)
 windmill (20)
 chicken coop (21)
 silo (22)
 windhouse (23)
 run trailer (24)
 other (25)

19. Surroundings: residential (1) semi-rural/commercial (2) commercial (3) rural (4) rural community (5) industrial (6) other (7)

20. ADDITIONAL DESCRIPTIVE COMMENTS: It consists block foundation rear portions, (1) opening returns, window trim, pilasters; rear gable and shed extensions also have opening returns; (2) peep grave.

21. ALTERATIONS Roof appears possibly altered c. 1930s.

HISTORICAL INFORMATION

22. Theme(s): _____ 23. Period(s): _____ 24. Important persons: _____

25. Architect(s): _____ Source: _____

26. Builder(s): _____ Source: _____

27. Historical Use: Originally a one-story, 2 room house c. 1820; part of back wing put on 1910 and house made two-story, porch built; S.H. Shover original owner.

28. Informant/Bibliography: Hugh Shover, Jr.

PROGRAM MANAGEMENT

29. Quadrangle name: 200000 30. Photographs: prints (1) slides (2) no

31. Other Documentation: survey back-up files (1) National Register files (2) air so files (3) grant files (4) state files (5) other (6)

32. Researcher name: The Sargent Company, Greenville, GA 33. Date recorded: 12/8/91



**South Carolina Statewide Survey Site Form
CONTINUATION AND PHOTOGRAPHS**

Control Number 11 / 21 / 0000 / 449 918
county census designated place site #

Continuation: _____

(Use grid for sketching)

(Attach photos here)



Photo #	Photo Index #	View of	N, S, E, W
<u>1</u>	<u>1-4</u>	<u>Front & S. Side</u>	<u>SE</u>
<u>2</u>	<u>1-5</u>	<u>Outbuildings</u>	<u>SW</u>
<u>3</u>	<u>1-6</u>	<u>Back</u>	<u>E</u>



Date Taken/Recorded by: 11/21/91, The Janger Co.

South Carolina Statewide Survey Site Form
CONTINUATION AND PHOTOGRAPHS



_____ 409 918

(Use grid for sketching)

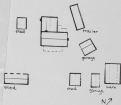

Photo #	Photo Index #	View of	N, S, E, W
1	3-4	Front & R. Side	SE
2	3-5	Back of house	SW
3	3-6	Shed	

