

Dorchester County  
Archives and History Center

South Carolina Statewide Survey Site Form  
State Historic Preservation Office  
P.O. Box 11669 • Columbia • SC • 29211 • (803) 734-8609



IDENTIFICATION

1. Control Number U / 35 / 1390 / 496 0555.00 2. NR Microfiche index # \_\_\_\_\_

3. Historic name(s): county census designated place site #  
White Gables

4. Common name: \_\_\_\_\_

5. Address/location: 603 West Richardson Ave.

City: Summerville Vicinity of: \_\_\_\_\_ County: Dorchester TMS: 137-02-14-07

6. Ownership: private  (1) city (2) county (3) state (4) federal (5) 9. Current use(s): single dwelling  (1) multi dwelling (2)

7. Category: building  (1) site (2) structure (3) object (4) commercial (3) other (0)

8. Historic use(s): single dwelling  (1) multi dwelling (2) commercial (3) 10. Potential: NR(1) NR historic district (2) archaeological (3)  
other (0)

11. Status/date: listed individually in National Register  /  /  name \_\_\_\_\_

listed as part of NR historic district 7/19/76 Name of district Summerville Historic District (#496-008)

#2A  contributing  non-contributing  
 listed individually National Historic Landmark  /  /   
 determined eligible—owner objection  /  /   
 determined NOT eligible  /  /   
 deferred by review board  /  /   
 rejected by Washington  /  /   
 pending federal nomination  /  /   
 completed Preliminary Information Sheet (PIS)  /  /   
 part of NHL district  /  /   
 DOE process  /  /   
 rejected by review board  /  /   
 removed from NR  /  /   
 removed from survey  /  /   
 demolished  /  /   
 nomination on file/never processed  /  /

12. Number of contributing properties: \_\_\_\_\_

PROPERTY DESCRIPTION: When other (0) is chosen, enter data on reverse side under category 20 or 21.

13. Construction Date 1835c 14. Alteration Date \_\_\_\_\_ 15. Architectural style or influence \_\_\_\_\_

16. Commercial Form — circle appropriate response(s)

- |                            |                           |                   |                          |
|----------------------------|---------------------------|-------------------|--------------------------|
| A) 2-part commercial block | D) stacked vertical block | G) temple front   | J) Central block w/wings |
| B) 1-part commercial block | E) 2-part vertical block  | H) vault          | K) arcaded block         |
| C) enframed window wall    | F) 3-part vertical block  | I) enframed block | 0) other                 |

17. DESCRIPTION: Select as many responses as appropriate.

- |   |   |   |  |
|---|---|---|--|
| <p>A) HISTORIC CORE SHAPE</p> <p>rectangular <input checked="" type="checkbox"/> (1)</p> <p>square (2)</p> <p>L (3)</p> <p>T (4)</p> <p>U (5)</p> <p>H (6)</p> <p>octagonal (7)</p> <p>irregular (8)</p> <p>other (0)</p> <p>B) STORIES</p> <p>1 story (1)</p> <p>1 1/2 stories <input checked="" type="checkbox"/> (2)</p> <p>2 stories (3)</p> <p>2 1/2 stories (4)</p> <p>3 stories (5)</p> <p>other (0)</p> <p>C) PORCH HEIGHT</p> <p>1 story <input checked="" type="checkbox"/> (1)</p> <p>1 story w/deck (2)</p> <p>2 or more stories (3)</p> <p>2 or more with tiers (4)</p> <p>roofed balcony over 1 story<br/>hip/shed (5)</p> <p>other (0)</p> | <p>D) ROOF SHAPE</p> <p>gable (end to front) (1)</p> <p>gable (lateral) <input checked="" type="checkbox"/> (2)</p> <p>hip (3)</p> <p>cross gable (4)</p> <p>pyramidal (5)</p> <p>flat (6)</p> <p>truncated hip (7)</p> <p>gambrel (8)</p> <p>mansard (9)</p> <p>salt box (10)</p> <p>jerkinhead (11)</p> <p>gable-on-hip (12)</p> <p>mono-pitch (14)</p> <p>not visible (15)</p> <p>other (0)</p> <p>E) PORCH WIDTH</p> <p>entrance bay only (1)</p> <p>over 1 bay, less than full<br/>facade (2)</p> <p>full facade <input checked="" type="checkbox"/> (3)</p> <p>facade &amp; left elevation (4)</p> <p>facade &amp; right elevation (5)</p> <p>facade &amp; both elevations (6)</p> <p>other (0)</p> | <p>F) PORCH ROOF SHAPE</p> <p>shed <input checked="" type="checkbox"/> (1)</p> <p>hip (2)</p> <p>gable (3)</p> <p>pedimented gable (4)</p> <p>flat (5)</p> <p>engaged (6)</p> <p>partially engaged (7)</p> <p>gable-on-hip or shed (8)</p> <p>engaged porte cochere (9)</p> <p>other (0)</p> <p>G) NUMBER OF CHIMNEYS</p> <p>1 exterior <input checked="" type="checkbox"/> (1)</p> <p>1 interior end (2)</p> <p>2 interior <input checked="" type="checkbox"/> (3)</p> <p>central (4)</p> <p>flue (5)</p> <p>double shouldered (6)</p> <p>not visible (7)</p> <p>other (0)</p> | <p>H) WINDOWS</p> <p>single <input checked="" type="checkbox"/> (1)</p> <p>double (2)</p> <p>tripartite (3)</p> <p>grouped (4)</p> <p>decorative (5)</p> <p>display (6)</p> <p>other (0)</p> <p>I) PANE CONFIGURATION</p> <p>tracered (1)</p> <p>Queen Anne block-glass (2)</p> <p>Prairie/bungalow/craftsman<br/>geometric (3)</p> <p>not visible (4)</p> <p>other (0)</p> <p><u>6/6</u> , <u>    </u> / <u>    </u></p> <p>J) DOORS</p> <p>single <input checked="" type="checkbox"/> (1)</p> <p>double (2)</p> <p>transom <input checked="" type="checkbox"/> (3)</p> <p>fanlight <input checked="" type="checkbox"/> (4)</p> <p>sidelight <input checked="" type="checkbox"/> (5)</p> <p>other (0)</p> |
|---|---|---|--|

Dorchester County  
Archives and History Center

**K) CONSTRUCTION METHOD**

- masonry (1)
- frame (2)
- log (3)
- steel (4)
- other (0)

**L) EXTERIOR WALLS**

- weatherboard (1)
- beaded weatherboard (2)
- shiplap (3)
- flushboard (4)
- wood shingle (5)
- stucco (6)
- tabby (7)
- brick (8)
- brick veneer (9)
- stone veneer (10)
- cast-stone (11)
- marble (12)
- asphalt roll (13)
- synthetic siding (14)
- asbestos shingle (15)
- pigmented structural glass (16)
- other (0)

**M) PORCH DETAILS**

- chamfered posts (1)
- turned posts (2)
- supports on pedestals (3)
- columns (4)
- posts (5)
- piers (6)
- pillars (7)
- freestanding posts (8)
- balustrade (9)
- apron wall (10)
- turned balusters (11)
- decorative sawn balusters (12)
- slat balusters (13)
- other sawn/turned work (14)
- insect screening (15)
- porte cochere (16)
- other (0)

**N) CHIMNEY MATERIAL**

- brick (1)
- stuccoed brick (2)
- stone (3)
- brick & stone (4)
- other (0)

**O) ROOF MATERIAL**

- composition shingle (1)
- pressed metal shingle (2)
- wood shingle (3)
- slate (4)
- raised seam metal (5)
- other metal (6)
- rolled roofing (7)
- not visible (8)
- tile (9)
- other (0)

**P) FOUNDATION**

- not visible (1)
- brick pier (2)
- brick pier with fill (3)
- brick (4)
- stuccoed masonry (5)
- stone pier (6)
- stone (7)
- concrete block (8)
- slab construction (9)
- basement (10)
- raised basement (11)
- other (0)

**Q) DECORATIVE ELEMENT**

- MATERIAL**
- cast iron (1)
  - pressed metal (2)
  - terra cotta (3)
  - granite (4)
  - marble (5)
  - cast stone (6)
  - brick (7)
  - wood (8)
  - pigmented glass (9)
  - stone (10)
  - stucco (11)
  - other (0)

**R) INTERIOR FEATURES (list)**

**18. HISTORIC OUTBUILDINGS AND STRUCTURES:**

- none (1)
- none visible (2)
- garage (3)
- garage w/ living area (4)
- shed (5)
- kitchen (6)

- tenant house (7)
- other house (8)
- office (9)
- barn (10)
- tobacco barn (11)
- dairy (12)

- crib (13)
- smokehouse (14)
- slave house (15)
- privy (16)
- well (17)
- springhouse (18)

- store (19)
- windmill (20)
- chicken coop (21)
- silos (22)
- washhouse (23)
- root cellar (24)
- other (0)

**19. SURROUNDINGS:** residential (1) residential/commercial (2) commercial (3) rural (4) rural community (5) industrial (6) other (0)  
8: boarding house/tourist hotel.

**20. ADDITIONAL DESCRIPTIVE COMMENTS:** C, E, F, & M: Rear porch with same details and entry as facade porch. M: False parapets at ends of both facade and rear porches.

P: Stuccoed masonry with stuccoed brick piers supporting porches. Three (CONT)

**21. ALTERATIONS** C, E, F, & M: Outside bays on either end of rear porch enclosed.

P: Raised basement converted into first level of house with entry. Space under (CONT)

**HISTORICAL INFORMATION**

22. Theme(s): \_\_\_\_\_ 23. Period(s): \_\_\_\_\_ 24. Important persons: \_\_\_\_\_

25. Architect(s): \_\_\_\_\_ Source: \_\_\_\_\_

26. Builder(s) \_\_\_\_\_ Source: \_\_\_\_\_

27. Historical data Built for railroad executive Henry T. Peake [or for his father John S.].  
From ca. 1914-1950 White Gables was a winter tourist home.

28. Informant/Bibliography Scott Hoyman, 3/29/96. Foster, Beth's Pineland Village, p. 18-20.

**PROGRAM MANAGEMENT**

29. Quadrangle name: Summerville, SC 30. Photographs: prints (1) slides (2) negatives (3)

31. Other documentation: survey back-up files (1) National Register files (2) tax act files (3) grant files (4) state historical marker files (5) environmental review files (6) HABS/HAER (7) SCIAA (8) other (0) # \_\_\_\_\_

32. Recorder name/firm Preservation Consultants: SD 33. Date recorded 3/29/1996

Dorchester County  
Archives and History Center

**South Carolina Statewide Survey Site Form  
CONTINUATION AND PHOTOGRAPHS**

Control Number U / 35 / 1390 / 496 0555 . 00  
county census designated place site #

**Continuation:**

20: pedimented gable dormers with single 6/6 windows on facade and rear. Gables of house are pedimented with tripartite windows. 18: Greenhouse.

21: rear porch enclosed.

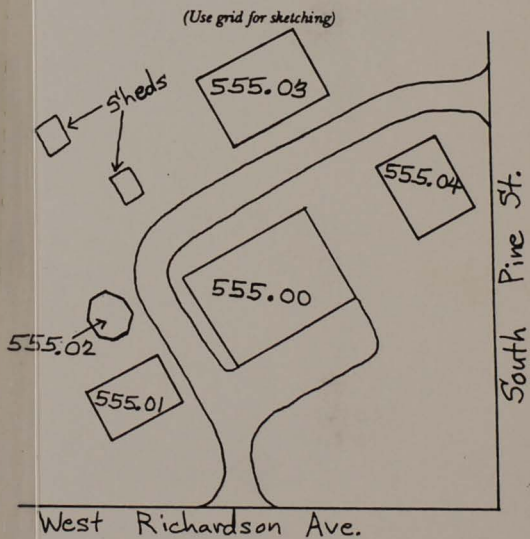
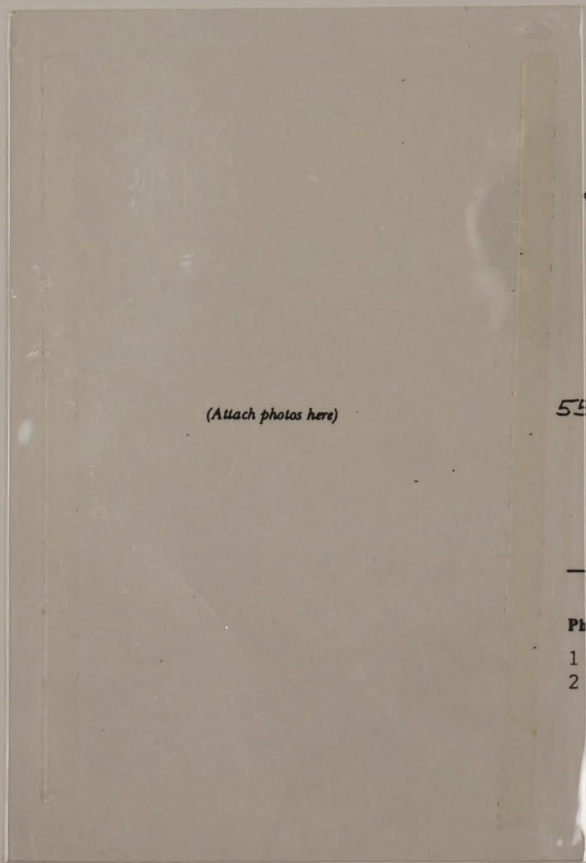

Photo #	Photo Index #	View of	N, S, E, W
1	D12, F25	Facade & Right	S
2	D12, F27	Facade & Left	S

Date Taken/Recorded by: 1996/ Preservation Consultants



Dorchester County  
Archives and History Center

